

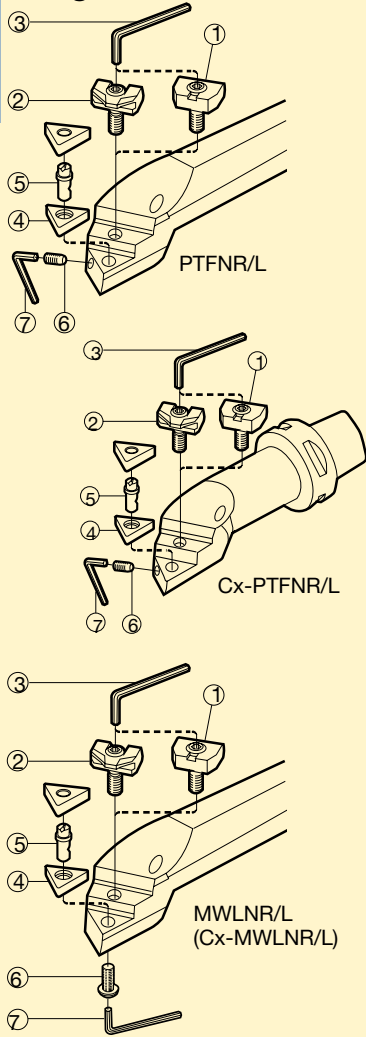

**T-MAX P wedge design**



Tool type		Standard parts				
		Delivered with the tool				
Round shank tools	Coromant Capto®	1	2	3	4	
		Wedge set	Wedge clamp set	Key (mm)	Shim	
 S25T-PTFNR/L 16-W S32U-PTFNR/L 16-W S40V-PTFNR/L 16-W	C3-PTFNR/L-17090-16-W C4-PTFNR/L-17090-16-W C5-PTFNR/L-17090-16-W	170.38-823-2	-	174.1-864 (3,0)	-	
	C3-PTFNR/L-22096-16-W C4-PTFNR/L-22110-16-W C4-PTFNR/L-27120-16-W C5-PTFNR/L-22110-16-W C5-PTFNR/L-27140-16-W C6-PTFNR/L-22110-16-W C6-PTFNR/L-27140-16-W	170.38-823-1	-	174.1-864 (3,0)	170.3-852	
	S50W-PTFNR/L 16-W S40V-PTFNR/L 22-W S50W-PTFNR/L 22-W	170.38-823-1 170.38-824-1	- -	174.1-864 (3,0) 3021 010-040 (4,0)	170.3-852 170.3-855	
	C5-PTFNR/L-27140-22-W C6-PTFNR/L-27140-22-W	170.38-823-1	-	3021 010-040 (4,0)	170.3-852	
 A20S-MWLNR/L 06 A25T-MWLNR/L 06 A32U-MWLNR/L 06 A25T-MWLNR/L 08 A32U-MWLNR/L 08 A40V-MWLNR/L 08 A50W-MWLNR/L 08	C3-MWLNR/L-13075-06M1 C3-MWLNR/L-17090-06M1 C4-MWLNR/L-13075-06M1 C4-MWLNR/L-17090-06	-	5431 125-011	170.3-860 (2,5)	-	
		-	5431 125-011	170.3-860 (2,5)	5322 331-11	
		-	5431 125-011	170.3-860 (2,5)	5322 331-06	
		C4-MWLNR/L-17090-08 C5-MWLNR/L-17090-08	-	5431 125-021	174.1-864 (3,0)	5322 331-09
		-	-	5431 125-021	174.1-864 (3,0)	5322 331-07
		C4-MWLNR/L-22110-08 C4-MWLNR/L-27120-08 C5-MWLNR/L-22110-08 C5-MWLNR/L-27140-08	-	5431 125-021	174.1-864 (3,0)	5322 331-07
			-	5431 125-021	174.1-864 (3,0)	5322 331-07

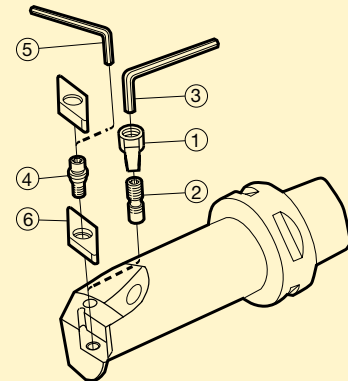

**T-MAX P screw and top clamp design**

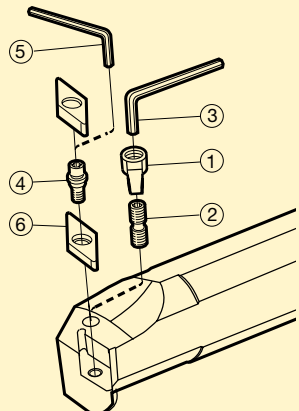

Tool type		Standard parts		
		Delivered with the tool		
Shank holders	Coromant Capto®	1	2	3
		Clamp	Clamp screw	Key (mm)
 35° S40V-MVUNR/L 16	C4-MVUNR/L-27120-16 C5-MVUNR/L-27140-16 C5-MVUNR/L-35150-16 C6-MVUNR/L-22120-16 C6-MVUNR/L-27145-16 C6-MVUNR/L-35175-16	MC-12	MS-510	3021 011-532 (3,96)

					<b>Optional parts</b>				
For insert		5	6	7	Delivery to separate order			For insert	
Thickness	Radius	Pin	Screw	Key (mm/Torx Plus)	2 Wedge clamp set	3 Key	4 Shim	Thickness	Radius
-	-	5313 021-01	5512 031-01	5680 051-03 (9IP)	-	-	-	-	-
4,76	0,4 – 0,8	5313 021-02	5512 031-01	5680 051-03 (9IP)	170.38-820-1	174.1-863 (2,5)	-	-	-
4,76	0,4 – 0,8	5313 021-02	3212 100-206	174.1-870 (1,98)	170.38-820-1	174.1-863 (2,5)	-	-	-
4,76	1,2 – 1,6	5313 021-03	5512 031-02	5680 049-02 (15IP)	170.38-821-1	174.1-864 (3,0)	170.3-856	4,76	0,4 – 0,8
4,76	1,2 – 1,6	5321 021-02	5512 031-01	5680 051-03 (9IP)	-	-	-	-	-
-	-	5313 022-02	-	170.3-864 (1,98)	-	-	-	-	-
4,76	0,4 – 0,8	5313 022-02	-	170.3-864 (1,98)	-	-	-	-	-
4,76	0,4 – 0,8	5313 022-01	5512 030-03	170.3-864 (1,98)	-	-	-	-	-
4,76	0,4 – 0,8	5313 022-03	-	-	-	-	5322 331-10	4,76	1,2 – 1,6
4,76	0,4 – 0,8	5313 022-03	-	-	-	-	5322 331-08	4,76	1,2 – 1,6
4,76	0,4 – 0,8	5313 022-03	5512 030-04	174.1-863 (2,5)	-	-	5322 331-08	4,76	1,2 – 1,6

Ordering example: 10 pieces 170.38-823-2

4	5	6	For insert	
Lock pin	Key (mm)	Shim	Thickness	Radius
MN-34L	174.1-870 (1,98)	MVN-322	4,76	0,4 – 1,2

Ordering example: 10 pieces MC-12