

Valve Technology, Extension force 40 N to 400 N (compressed up to 560 N)

**End Fitting**

**Standard Dimensions**

**End Fitting**

**A5**

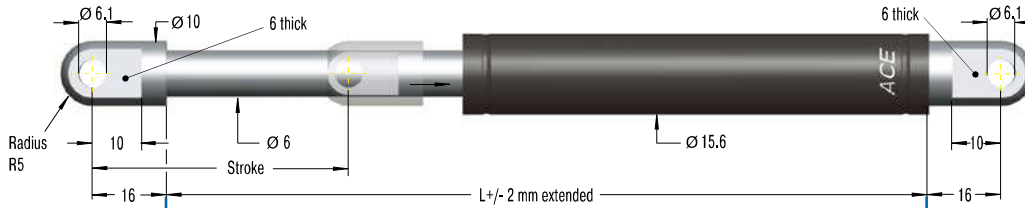

**Eye A5**  
max. force 800 N

**B5**

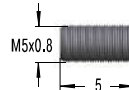

**Stud Thread B5**

**C5**

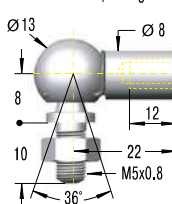

**Angle Ball Joint C5**  
max. force 500 N

**D5**

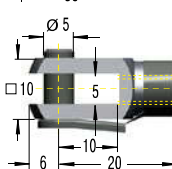

**Clevis Fork D5**  
max. force 800 N

**E5**

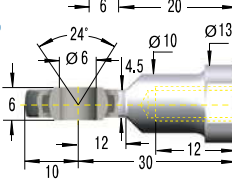

**Swivel Eye E5**  
max. force 800 N

**F5**

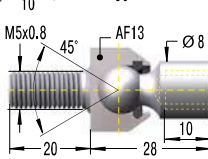

**Inline Ball Joint F5**  
max. force 500 N

**G5**

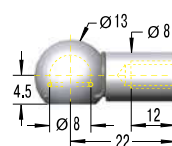

**Ball Socket G5**  
max. force 500 N

**Rod Shroud W5-15**

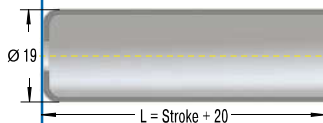

**Performance and Dimensions**

| TYPES     | Stroke<br>mm | L extended<br>mm | Extension force max.<br>N |
|-----------|--------------|------------------|---------------------------|
| GS-15-20  | 20           | 67               | 400                       |
| GS-15-40  | 40           | 107              | 400                       |
| GS-15-50  | 50           | 127              | 400                       |
| GS-15-60  | 60           | 147              | 400                       |
| GS-15-80  | 80           | 187              | 400                       |
| GS-15-100 | 100          | 227              | 400                       |
| GS-15-120 | 120          | 267              | 400                       |
| GS-15-150 | 150          | 327              | 400                       |
| GS-15-200 | 200          | 427              | 350                       |

**Ordering Example**

Type (Push Type) \_\_\_\_\_  
 Body Ø (15.6 mm) \_\_\_\_\_  
 Stroke (150 mm) \_\_\_\_\_  
 Piston Rod End Fitting A5 \_\_\_\_\_  
 Body End Fitting C5 \_\_\_\_\_  
 Nominal Force F<sub>1</sub> 150 N \_\_\_\_\_

**GS-15-150-AC-150**

Mounting accessories see from page 200.

**Adjuster Knob DE-GAS-5**  
See page 175.

**Technical Data**

**Extension force:** 40 N to 400 N (compressed up to 560 N)

**Progression:** Approx. 30 % to 40 %

**Operating temperature range:** -20 °C to +80 °C

**Material:** Outer body: steel coated with UV paint; Piston rod: steel with wear-resistant coating; End fittings: zinc plated steel

**Mounting:** We recommend mounting with piston rod downwards to take advantage of the built-in end position damping.

**End position damping length:** approx. 10 mm (depending on the stroke)

**Positive stop:** External positive stop at the end of stroke provided by the customer.

**Note:** Increased break-away force if unit has not moved for some time.

**End fittings:** They are interchangeable and if necessary must be positively secured by the customer to prevent unscrewing.

**Safety instructions:** Gas springs (push type) should not be installed under pre-tension.

