

ABB MEASUREMENT & ANALYTICS | DATA SHEET

# TZIDC

## Digital positioner



## ... Specification

### Accessories

#### Mounting material

- Attachment kit for linear actuators in accordance with DIN / IEC 534 / NAMUR
- Attachment kit for rotary actuators in accordance with VDI / VDE 3845
- Attachment kit for integral mounting
- Attachment kit for actuator-specific mounting

#### Pressure gauge block

- With pressure gauges for supply air and output pressure. Pressure gauges with housing  $\varnothing$  28 mm (1.10 in), with connection block in aluminum, black
- Installation material in black for mounting on positioner

#### Filter regulator

All metal version in brass, varnished black, bronze filter element (40  $\mu$ m), with condensate drain.  
Max. pre-pressure 16 bar (232 psi).

Output can be adjusted to:

- 1.4 to 6 bar (20 to 90 psi)

Marine version:

- 1.6 to 5.5 bar (23 to 80 psi)

The filter regulator may only be installed in combination with the pressure gauge block (accessory).

#### PC adapter for communication

- LCI adapter – USB for plug connection to positioner
- HART® – USB modem for HART communication

#### Control program for operation and parameterization on a PC

DAT200 Asset Vision Basic with DTM for TZIDC / TZIDC-200 on CD-ROM.

- Download DTM for TZIDC at [www.abb.com/positioners](http://www.abb.com/positioners).
- Download ABB Ability™ Field Information Manager (FIM) and FDI package at: [solutions.abb/fieldinfo](http://solutions.abb/fieldinfo).

### Housing

#### Material / IP rating

Aluminum with  $\leq$  0.1% copper

IP rating IP 65 / NEMA 4X (NEMA 4X does not permit overhead mounting),  
(IP 66, optional)

#### Surface/color

Dipping varnish With epoxy resin, stove-hardened

Housing varnished matt black RAL 9005

Case cover Pantone 420

#### Weight

Aluminum 1.7 kg (3.75 lb)

#### Mounting orientation

Any

## Dimensions

All dimensions in mm (in)

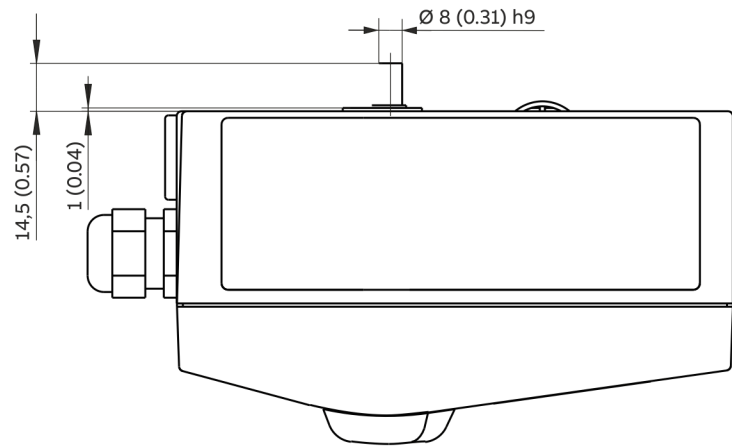
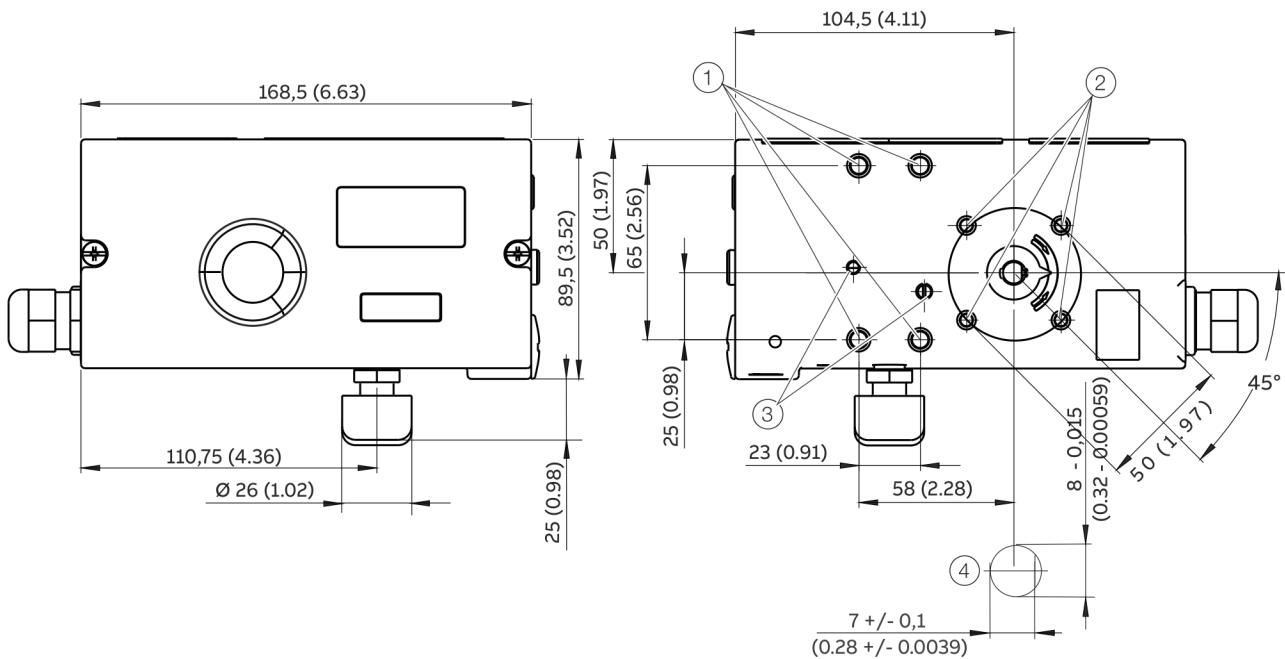

Figure 14: Top view



① Tap hole M8 (10 mm [0.39 in] deep)

② Tap hole M6 (8 mm deep [0.31 in])

③ Threaded hole M5 × 0.5 (air outputs for direct mount)

④ Sensor shaft (shown larger than scale)

Figure 15: Front and rear view